

Notes: (Unless Otherwise Specified)

1. Waterproof Rate : IP67.
2. Recommend Panel Thickness : 0.8 to 3.0 mm.
3. Recommend Torque: 9~10 Kgf-cm.
4. Mating Cap P/N: GT1C1210X2.
5. RoHS Compliant.
6. UL Certification file #E364108.
7. Type C -Pin Out Is The Same As This Drawing.

REV	ECN#	DESCRIPTION OF REVISION	DRAW BY DATE	CHECK BY DATE	APPROVE BY DATE
A0			Lucas 03/25/26	Lucas 03/25/26	Ray 03/25/26

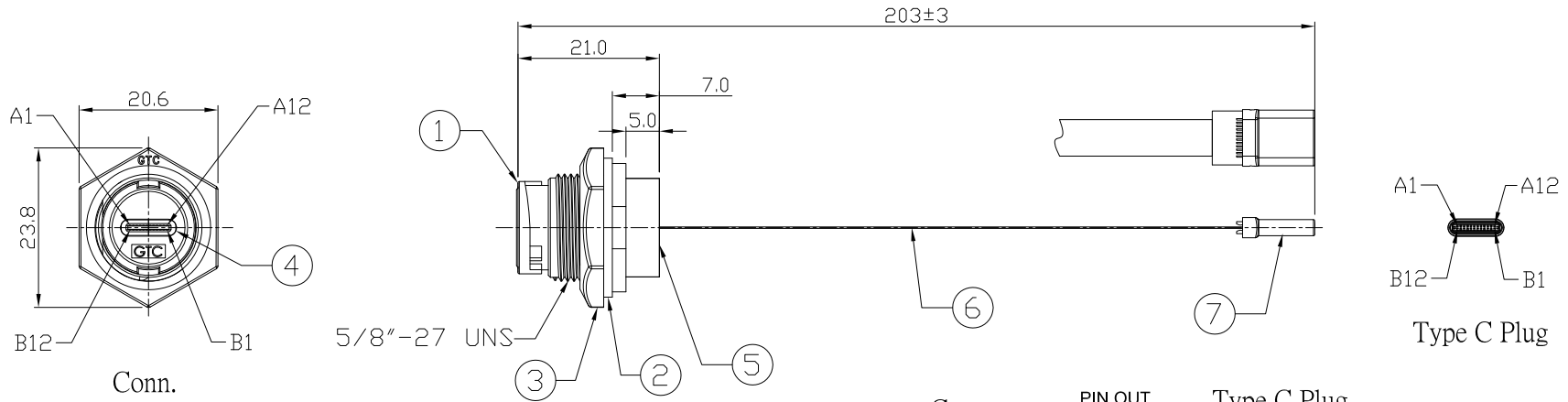

Conn.	PIN OUT	Type C Plug
A4,B4,A9,B9	—————	A4,B4,A9,B9
SHELL ,A1,B1,A12,B12	—————	SHELL ,A1,B1,A12,B12
A2	—————	A2
A3	—————	A3
A5	—————	A5
A6,B6	—————	A6,B6
A7,B7	—————	A7,B7
A8	—————	A8
A10	—————	A10
A11	—————	A11
B2	—————	B2
B3	—————	B3
B5	—————	B5
B8	—————	B8
B10	—————	B10
B11	—————	B11

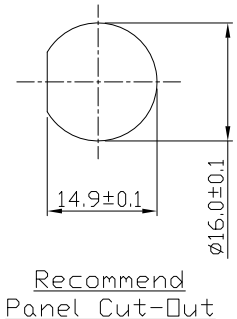

Item	Part Name	Material / Finish	Qty
7	USB Type C 3.1 Male	Housing: Thermoplastic, Color: Black Contacts: Copper Alloy, Finish: Au Plated Shell: Stainless Steel, Finish: Ni Plated	1
6	FPC	FPC	1
5	Glue	Epoxy Color: Black	1
4	USB Type C 3.1 Female	Housing: Thermoplastic, Color: Black Contacts: Copper Alloy, Finish: Au Plated Shell: Stainless Steel, Finish: Ni Plated	1
3	Hex Nut	Thermoplastic Color: Black	1
2	Gasket	Silicone Color: Black	1
1	Housing	Thermoplastic Color: Black	1

TITLE						DRAWING NUMBER			REV.
USB 3.1 Type C Plastic C2 Panel Jack Lock With Type C Plug						GT11C200-CS-FPC-Z2			A0
THIRD ANGLE PROJECTION	SIZE	SCALE	DRAW / DATE	CHECK / DATE	APPROVE / DATE	TOLERANCES		UNIT	SHEET
	B	1:1	Lucas 03/25/26	Lucas 03/25/26	Ray 03/25/26	X.X ± 0.5 X.XX ± 0.2	X.XXX ± 0.05 ANGLES ± 1°	mm	1/1

GT Contact CO.,LTD

NOTICE OF PROPRIETARY PROPERTY:
THE INFORMATION CONTAINED HEREIN IS THE PROPRIETARY PROPERTY OF GT Contact CO.,LTD THE POSSESSOR AGREES TO THE FOLLOWING:
(a) TO MAINTAIN THIS DOCUMENT IN CONFIDENCE
(b) NOT TO REPRODUCE OR COPY IT
(c) NOT TO REVEAL OR PUBLISH IT IN WHOLE OR PART
(d) ALL RIGHTS RESERVED