



CORCOM Filter Products

SRB Series

Small Sized IEC-Filter

Sehr kompakter IEC-Filter

General Information / Allgemeine Informationen

- One of the smallest footprints available on the market
 - Compact dimensions
 - Easy-to-install design
 - Complete Shield design
 - Various capacitance values
 - Varying levels of common mode performance
 - Snap-in or flange mounting
 - Different terminal types
 - Suitable for power supplies or other applications requiring minimum footprint
- Eine der geringsten Einbautiefen am Markt
 - Kompakte Abmessungen
 - Einfache Montage
 - Vollständig geschirmtes Gehäuse
 - Mehrere unterschiedliche Kapazitätswerte
 - Unterschiedliche Dämpfungseigenschaften bei asymmetrischen Störungen
 - Einschub- oder Schraubmontage
 - Verschiedene Anschlussvarianten
 - Verwendbar für Stromversorgungen oder andere Anwendungen, die eine sehr kleine Lösung benötigen



Electrical Specifications / Elektrische Eigenschaften

Maximum leakage current, each line to ground
Maximaler Ableitstrom, je Phase zu Erde

Capacitor ID / Value Kondensator ID / Wert	@ 120 VAC 60 Hz	@ 250 VAC 50 Hz
Blank / None / Ohne / kein Wert	2 µA	5 µA
Q / 33 pF	2,1 µA	3,65 µA
R / 100 pF	9,6 µA	16,6 µA
S / 220 pF	19,2 µA	33,2 µA
T / 330 pF	24,0 µA	41,5 µA
W / 470 pF	0,04 mA	0,07 mA
X / 1000 pF	0,07 mA	0,13 mA
Y / 2200 pF	0,16 mA	0,28 mA
Z / 3300 pF	0,24 mA	0,42 mA

Hipot rating (one minute) / Hochspannungsfestigkeit (eine Minute)

line to ground / Phase zu Erde 1500 VAC
 line to line / Phase zu Phase 1450 VDC

Operating Frequency / Nennfrequenz 50 / 60 Hz

Rated voltage (max.) / Nennspannung (max.) 250 VAC

Electrical Schematic / Elektrischer Schaltplan

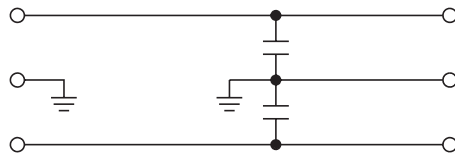

Ordering Information / Bestellinformationen

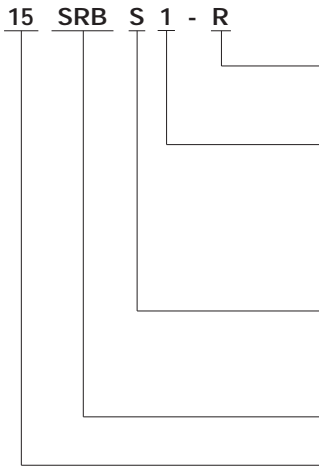

Capacitor Value ID / Identifikation Kondensatorwert - / Q / R / S / T / W / X / Y / Z
For value identification see specifications / zur Wertermittlung siehe Elektrische Eigenschaften

Terminal Type / Anschlussart
1 – FASTON 6,35 mm
2 – FASTON 6,35 mm angle 90° / abgewinkelt
P – PCB Pins / Leiterplattenmontage
8 – Wire Leads AWG18 / Kabelanschluss AWG18

Installation / Einbauart
S – Snap In
None – Flange Mounting / Ohne – Schraubmontage

SRB Series

Current Rating / Stromstärke (UL 15 A / VDE 10 A)

SRB-Series

Type	Order no.	Max. current UL/VDE	Capacitor value identifier	Capacitor value
15SRB1	6609987-9	15 A / 10 A	Blank	None
15SRB2	5-6609987-4	15 A / 10 A	Blank	None
15SRB8	1-6609987-8	15 A / 10 A	Blank	None
15SRBP	4-6609987-5	15 A / 10 A	Blank	None
15SRB1-Q	6609987-1	15 A / 10 A	Q	33 pF
15SRB2-Q	4-6609987-6	15 A / 10 A	Q	33 pF
15SRB8-Q	1-6609987-0	15 A / 10 A	Q	33 pF
15SRBP-Q	3-6609987-7	15 A / 10 A	Q	33 pF
15SRB1-R	6609987-2	15 A / 10 A	R	100 pF
15SRB2-R	4-6609987-7	15 A / 10 A	R	100 pF
15SRB8-R	1-6609987-1	15 A / 10 A	R	100 pF
15SRBP-R	3-6609987-8	15 A / 10 A	R	100 pF
15SRB1-S	6609987-3	15 A / 10 A	S	220 pF
15SRB2-S	4-6609987-8	15 A / 10 A	S	220 pF
15SRB8-S	1-6609987-2	15 A / 10 A	S	220 pF
15SRBP-S	3-6609987-9	15 A / 10 A	S	220 pF
15SRB1-T	6609987-4	15 A / 10 A	T	330 pF

Type	Order no.	Max. current UL/VDE	Capacitor value identifier	Capacitor value
15SRB2-T	4-6609987-9	15 A / 10 A	T	330 pF
15SRB8-T	1-6609987-3	15 A / 10 A	T	330 pF
15SRBP-T	4-6609987-0	15 A / 10 A	T	330 pF
15SRB1-W	6609987-5	15 A / 10 A	W	470 pF
15SRB2-W	5-6609987-0	15 A / 10 A	W	470 pF
15SRB8-W	1-6609987-4	15 A / 10 A	W	470 pF
15SRBP-W	4-6609987-1	15 A / 10 A	W	470 pF
15SRB1-X	6609987-6	15 A / 10 A	X	1000 pF
15SRB2-X	5-6609987-1	15 A / 10 A	X	1000 pF
15SRB8-X	1-6609987-5	15 A / 10 A	X	1000 pF
15SRBP-X	4-6609987-2	15 A / 10 A	X	1000 pF
15SRB1-Y	6609987-7	15 A / 10 A	Y	2200 pF
15SRB2-Y	5-6609987-2	15 A / 10 A	Y	2200 pF
15SRBP-Y	4-6609987-3	15 A / 10 A	Y	2200 pF
15SRB1-Z	6609987-8	15 A / 10 A	Z	3300 pF
15SRB2-Z	5-6609987-3	15 A / 10 A	Z	3300 pF
15SRBP-Z	4-6609987-4	15 A / 10 A	Z	3300 pF

SRBS-Series

Type	Order no.	Max. current UL/VDE	Capacitor value identifier	Capacitor value
15SRBS1	2-6609987-7	15 A / 10 A	Blank	None
15SRBS8	3-6609987-6	15 A / 10 A	Blank	None
15SRBS1-Q	1-6609987-9	15 A / 10 A	Q	33 pF
15SRBS8-Q	2-6609987-8	15 A / 10 A	Q	33 pF
15SRBS1-R	2-6609987-0	15 A / 10 A	R	100 pF
15SRBS8-R	2-6609987-9	15 A / 10 A	R	100 pF
15SRBS1-S	2-6609987-1	15 A / 10 A	S	220 pF
15SRBS8-S	3-6609987-0	15 A / 10 A	S	220 pF

Type	Order no.	Max. current UL/VDE	Capacitor value identifier	Capacitor value
15SRBS1-T	2-6609987-2	15 A / 10 A	T	330 pF
15SRBS8-T	3-6609987-1	15 A / 10 A	T	330 pF
15SRBS1-W	2-6609987-3	15 A / 10 A	W	470 pF
15SRBS8-W	3-6609987-2	15 A / 10 A	W	470 pF
15SRBS1-X	2-6609987-4	15 A / 10 A	X	1000 pF
15SRBS8-X	3-6609987-3	15 A / 10 A	X	1000 pF
15SRBS1-Y	2-6609987-5	15 A / 10 A	Y	2200 pF
15SRBS1-Z	2-6609987-6	15 A / 10 A	Z	3300 pF

Case Styles / Gehäuseformen

SRB1

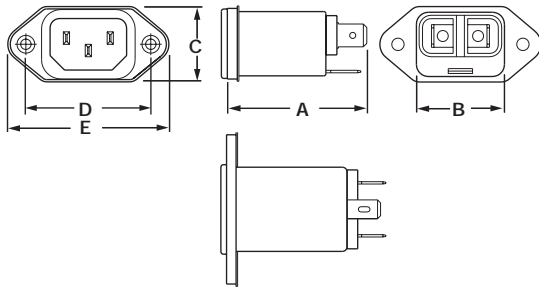

SRB2

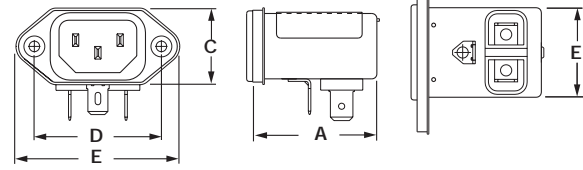

SRBP

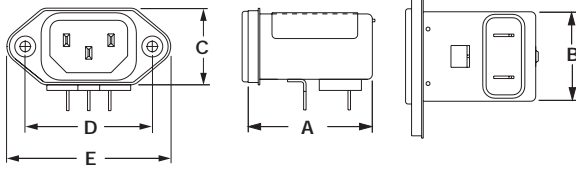

SRB8

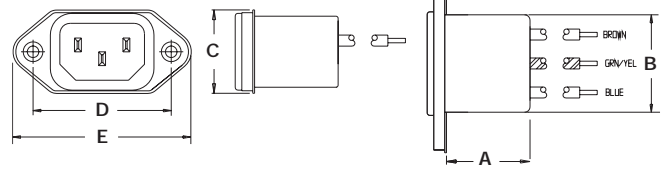

SRBS1

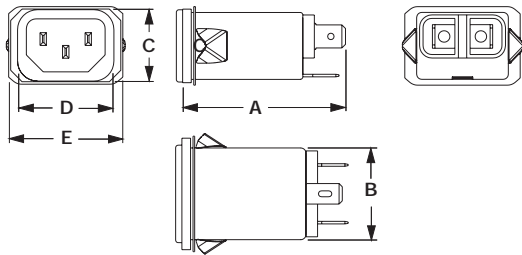

SRBS8

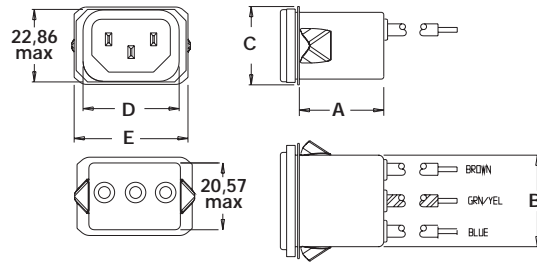

Case Dimensions / Gehäuseabmessungen

Typ	A (max)	B (max)	C (max)	D (+/-0.38)	E (max)
15SRB1	44,45	28,70	24,38	40,00	51,76
15SRB2	39,12	28,70	24,38	40,00	51,76
15SRBP	39,12	28,70	24,38	40,00	51,76
15SRB8	23,82	28,70	24,38	40,00	51,76
15SRBS1	44,45	28,70	24,38	30,10	35,81
15SRBS8	28,45	28,70	24,38	30,10	35,81

PC Board Layout for SRBP / Platinenbohrungen für SRBP

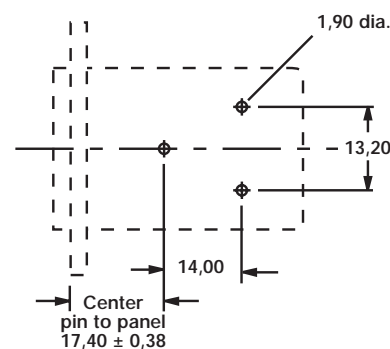

Recommended Panel Cutouts / Gehäuseausschnitt

SRB

Back mounted
 Rückseitenmontage
 (SRB1 / SRB2 / SRB8 / SRBP)

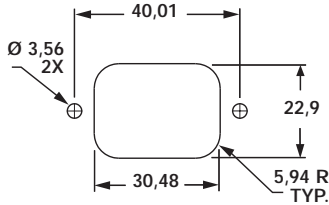

Tolerance / Toleranz
 Panel thickness / Stärke Montageplatte

Front mounted
 Frontmontage
 (SRB1 / SRB8)

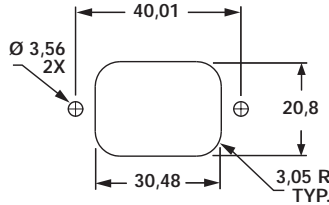

+/-0,13 mm
 0,78 – 1,19 mm

SRBS

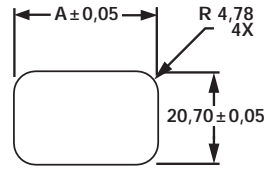

Panel thickness
 Stärke Montageplatte
 0,790 – 1,320 mm
 1,117 – 1,730 mm

Dim. A +/-0,05 mm
 Maß A +/-0,05 mm
 32,00 mm
 34,29 mm

Typical Dimensions / Typische Abmessungen

FASTON	6,35 mm
- Holes / Löcher	1,80 mm
- Slot / Langloch (GND)	1,80 x 4,10 mm
Wire Leads / Kabelanschluß	100 mm (min); AWG18
Mounting Holes countersunk / Montagelöcher eingesenkt	3,35 mm

Typ. Insertion Loss / Beispiel typischer Einfügungsdämpfung

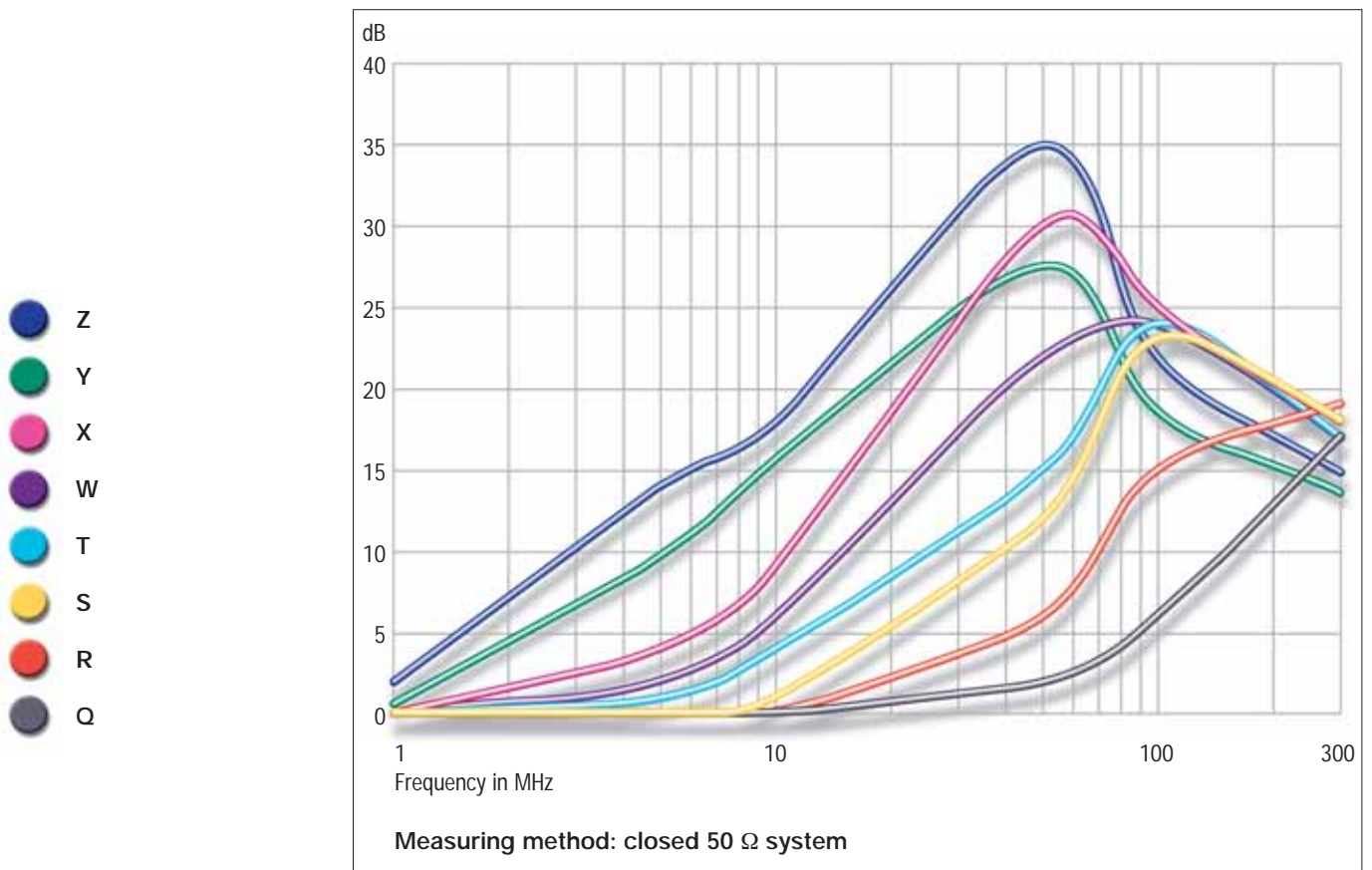

Europe/Middle East/Africa

Austria – Vienna

Phone: +43-1-905-60-0
Fax: +43-1-905-60-1333

Product Information Center:

Phone: +43-1-905-60-1249
Fax: +43-1-905-60-1251

Belarus – Minsk

Phone: +375 17 237 47 94
Fax: +375 17 237 47 94

Belgium – Kessel-Lo

Phone: +32-16-352-300
Fax: +32-16-352-352

Bulgaria – Sofia

Phone: +359-2-971-2152
Fax: +359-2-971-2153

Czech Republic and Slovakia

Czech Republic – Kurim

Phone: +420-541-162-111
Fax: +420-541-162-223

Product Information Center:

Phone: +420-541-162-113
Fax: +420-541-162-132

Denmark – Glostrup

Phone: +45-43-48-04-00
Fax: +45-43-44-14-14

Egypt – Cairo

Phone: +202-419-2334
Fax: +202-417-7647

Estonia – Tartu

Phone: +372-5138-274
Fax: +372-7400-779

Finland – Helsinki

Phone: +358-95-12-34-20
Fax: +358-95-12-34-250

France – Cergy-Pontoise Cedex

Phone: +33-1-3420-8888
Fax: +33-1-3420-8600

Product Information Center:

Phone: +33-1-3420-8686
Fax: +33-1-3420-8623

France Export Divisions –

Cergy-Pontoise Cedex
Phone: +33-1-3420-8804
Fax: +33-1-3420-8699

Germany – Bensheim

Phone: +49-6251-133-0
Fax: +49-6251-133-1600

Product Information Center:

Phone: +49-6251-133-1999
Fax: +49-6251-133-1988

Greece – Athens

Phone: +30-210-9370-396/397
Fax: +30-210-9370-655

Hungary – Budapest

Phone: +36-1-289-1000
Fax: +36-1-289-1010

Product Information Center:

Phone: +36-1-289-1016
Fax: +36-1-289-1017

Ireland – Dublin

Phone: +353-1-866-5612
Fax: +353-1-866-5714

Israel – Petach-Tikva

Phone: +972-3-929-0999
Fax: +972-3-919-1088

Italy – Collegno (Torino)

Phone: +39-011-4012-111
Fax: +39-011-4031-116

Product Information Center:

Phone: +39-011-4012-428
Fax: +39-011-40-287-428

Lithuania and Latvia

Lithuania – Vilnius

Phone: +370-5-213-1402
Fax: +370-5-213-1403

Product Information Center:

Phone: +370-5-211-3016
Fax: +370-5-213-1403

Netherlands – 's-Hertogenbosch

Phone: +31-73-6246-246
Fax: +31-73-6212-365

Product Information Center:

Phone: +31-73-6246-999
Fax: +31-73-6246-998

Norway – Nesbru

Phone: +47-66-77-88-50
Fax: +47-66-77-88-55

Poland – Warsaw

Phone: +48-22-4576-700
Fax: +48-22-4576-720

Product Information Center:

Phone: +48-22-4576-704
Fax: +48-22-4576-720

Romania – Bucharest

Phone: +40-21-311-3479/3596
Fax: +40-21-312-0574

Russia – Moscow

Phone: +7-495-790-7902
Fax: +7-495-721-1893

Product Information Center:

Phone: +7-495-790-7902-404
Fax: +7-495-790-7902-401

Russia – St. Petersburg

Phone: +7-812-718-8192
Fax: +7-812-718-8193

Slovenia – Ljubljana

Phone: +386-1561-3270
Fax: +386-1561-3240

South Africa – Port Elizabeth

Phone: +27-41-503-4500
Fax: +27-41-581-0440

Spain – Barcelona

Phone: +34-93-291-0330
Fax: +34-93-201-7879

Sweden – Upplands Väsby

Phone: +46-8-50-72-50-00
Fax: +46-8-50-72-50-01

Switzerland – Steinach

Phone: +41-71-447-0447
Fax: +41-71-447-0444

Turkey – Istanbul

Phone: +90-212-281-8181/2/3
+90-212-282-5130/5430
Fax: +90-212-281-8184

Ukraine – Kiev

Phone: +380-44-206-2265
Fax: +380-44-206-2264

Product Information Center:

Phone: +380-44-206-2265
Fax: +380-44-206-2264

United Kingdom –

Stanmore, Middlesex

Phone: +44-8706-080208
Fax: +44-208-954-6234

Product Information Center:

Freephone (UK only):
0800-267-666
Phone: +44-8706-080208
Fax: +44-208-420-8095

Tyco Electronics AMP GmbH
Finsinger Feld 1
85521 Ottobrunn
Phone: +49-(0)89 6089-0
Fax: +49-(0)89 6089-767

www.tycoelectronics.com
CORCOM, TE Logo and Tyco Electronics
are Trademarks.

© 2008 Tyco Electronics Ltd.
3-1654249-1 Issued 03-2008 5M ST